

Summer Research Seminar

UNT UNIVERSITY OF NORTH TEXAS
Discover the power of ideas.

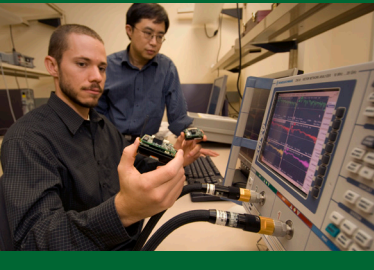
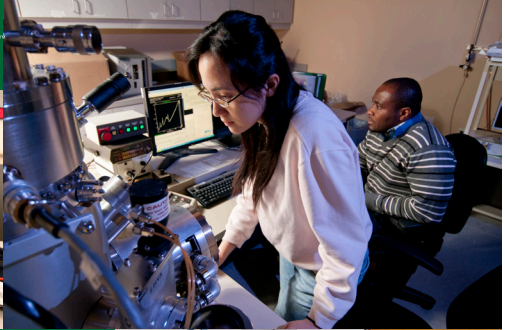

Toulouse
Graduate School
2011

CONTENTS

Welcome 1

Agenda 2

Speakers 8

Participants 10

Notes 13

Campus Map 14

Campus Map Detail 16

Program Contacts 16

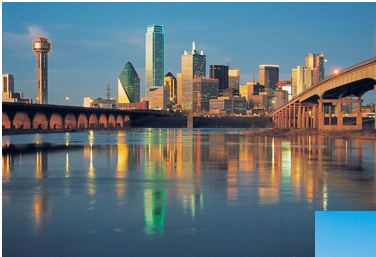

Dallas, Texas

Fort Worth, Texas



*The University of North Texas
is near two outstanding
metropolitan areas*

WELCOME



On behalf of the University of North Texas and the Toulouse Graduate School, I am pleased to welcome you to our first Summer Research Seminar. We have brought you—the top undergraduates from across Texas and the surrounding states—to UNT to learn more about research and to have a great time getting to know Denton and the Dallas/Fort Worth area.

UNT is an outstanding public research university with 88 master's programs and 40 doctoral programs. Together, UNT faculty and students collaborate on a tremendous variety of research and creative activities, spanning fields from art education to engineering to the xylophone.

During this week-long seminar, you have the opportunity to explore your interests with our faculty and students. We invite you to learn about the cutting edge research, performances, and other activities here at UNT that are shaping our world.

You will also get to explore what makes the D/FW area so much fun—everything from cows and great Tex-Mex food to major league baseball. We are delighted you are here and look forward to a great week. If you need anything or have any questions, please contact me or any of the UNT faculty, staff and students who will be working with you.

Have an awesome week!

Jim Meernik
Acting Dean, Toulouse Graduate School

AGENDA - Sunday June 5

3:00-4:30 pm	Check-in / unpack	UNT Honors Hall
5:00-7:00 pm	Welcome Dinner	Honors Hall Courtyard

UNT by the Numbers

10
median graduate
class size

900
teaching fellows
& assistants

1,700
master's degrees
awarded annually

200
doctoral degrees
awarded annually

AGENDA - Monday June 6

7:00–8:30 am Breakfast Kerr Hall Cafeteria

8:45 am Meet outside to walk to presentation

9:00–11:45 am Presentation Gateway 131

“The Scope and Importance of Research,” Dr. Denise Perry Simmons, Senior Director of Research Development, Office of Research and Economic Development

Noon–1:00 pm Lunch Kerr Hall Cafeteria

1:00–4:30 pm Campus tour Begin in Kerr Hall

5:00–6:00 pm Dinner Kerr Hall Cafeteria

6:00–9:30 pm Graduate student panel and movie ESSC 255

Naturally Obsessed: The Making of a Scientist follows graduate students in a research lab, revealing the work and tenacity required to successfully complete a doctoral degree

AGENDA - Tuesday June 7

7:00–8:30 am	Breakfast	Kerr Hall Cafeteria
8:45 am	Meet outside to walk to presentation	
9:00–11:45 am	Presentation	Gateway 131
	<p>"Responsible Conduct of Research," Dr. J. Britt Holbrook, <i>Research Assistant Professor and Assistant Director, Center for the Study of Interdisciplinarity</i></p>	
Noon–1:00 pm	Lunch	Kerr Hall Cafeteria
1:30–4:30 pm	Visit with UNT faculty based on student interests	Campus locations vary
5:00 pm	Board bus near stairs	Willis Library Mall
6:00–9:00 pm	Texas Rangers baseball / dinner	Ballpark in Arlington
	<p>The Detroit Tigers go to bat against the Texas Rangers, winners of the 2010 American League Pennant</p>	

AGENDA - Wednesday June 8

7:00–8:30 am	Breakfast	Kerr Hall Cafeteria
8:45 am	Meet outside to walk to presentation	
9:00–11:45 am	Presentation	Gateway 131
	<i>“Research Methods,” Dr. Mark Vosvick, Associate Professor of Psychology and Co-Director of Center for Psychosocial Health Research</i>	
Noon–1:00 pm	Lunch	Kerr Hall Cafeteria
1:30–4:30 pm	Visit with UNT faculty based on student interests	Campus locations vary
5:00–6:00 pm	Dinner	Kerr Hall Cafeteria
7:30 pm	Meet to go to Sky Theatre (optional)	Lobby of Honors Hall
8:00–9:00 pm	Pink Floyd movie (optional)	Sky Theatre / Env. Sci. Bldg.
	<i>Enjoy Pink Floyd's Dark Side of the Moon in UNT's unique 100-seat, 40-foot domed planetarium</i>	

AGENDA - Thursday June 9

7:00 – 8:00 am	Breakfast	Kerr Hall Cafeteria
8:15 am	Meet outside to walk to presentation	
8:30–9:30 am	Presentation	Gateway 131
	<p>“Planning Your Future,” Dr. James Meernik, <i>Acting Dean</i> <i>Toulouse Graduate School</i></p>	
9:30 am	Board bus for Fort Worth	Outside Gateway
10:00 am–5:00 pm	Trip to Fort Worth	Fort Worth
	<p>Visit Fort Worth Stockyards Lunch at Joe T. Garcia’s Choice of Kimball Art Museum, Amon Carter Museum, or Fort Worth Museum of Modern Art</p>	
5:30–6:15 pm	Arrive back on campus	
7:00–9:00 pm	Green and White Banquet	Gateway 34 Ballroom

AGENDA - Friday June 10

7:00 – 8:30 am	Breakfast	Kerr Hall Cafeteria
8:45 am	Meet outside to walk to closing session	
9:00–11:00 am	Closing session	Gateway 131
	Share thoughts on the week and consider future plans Bonus: “Pursuing National Science Foundation Graduate Research Fellowships” with Dr. Joseph Oppong, <i>Professor of Geography and co-director of the Center for Computational Epidemiology and Response Analysis</i>	
11:00–11:30 am	Pack up room	Honors Hall
11:30 am–Noon	“Grab and Go” Lunch	Kerr Hall Cafeteria
Noon–1:00 pm	Pack and check-out	

SPEAKERS

Dr. Denise Perry Simmons

Senior Director of Research Development

Leader of UNT's Research Development Team, Dr. Denise Perry Simmons has more than 30 years of experience in cancer research and holds patents in cancer treatments and publication credits in leading journals. She has prepared proposals that secured millions of dollars of grant funding for cancer research and clinical studies of cutting-edge therapies. Dr. Simmons directed clinical research at John Theurer Cancer Center in New Jersey, was a board member of New Jersey's Commission on Cancer Research, and spent five years as a research fellow at the National Cancer Institute of the National Institutes of Health. She holds a combined Ph.D. degree in biology from the University of Texas and cancer research from U.T.M.D. Anderson.

Dr. J. Britt Holbrook

Research Assistant Professor and Assistant Director, Center for the Study of Interdisciplinarity

Dr. J. Britt Holbrook is an international expert in peer review and policy impacts in the STEM areas - science, technology, engineering, and mathematics. Through his work with UNT's innovative Center for the Study of Interdisciplinarity (CSID), Dr. Holbrook helped secure a three-year grant from the National Science Foundation to explore scientific autonomy and accountability in U.S. and foreign public agencies. He was managing editor and contributor to *The Oxford Handbook of Interdisciplinarity*, has co-organized workshops for the European Commission and Carnegie Endowment for International Peace, and participated at top national science policy events. He received his Ph.D. in Philosophy from Emory University.

SPEAKERS

Dr. Mark Vosvick

Associate Professor of Health Psychology and Behavioral Medicine, Psychology Department

As a co-director of UNT's interdisciplinary Center for Psychosocial Health Research, Dr. Mark Vosvick researches quality of life issues, coping styles, and forgiveness in AIDS/HIV patients, and he has written numerous successful proposals that received grant funding in these areas. Dr. Vosvick has been a panelist for NIH Scientific Reviews and received a NIMH Postdoctoral Fellowship at the Center for AIDS Intervention Research at the Medical College of Wisconsin. Dr. Vosvick received his M.B.A. from Rutgers University, M.Ed. from Harvard, and Ph.D. in Counseling and Health Psychology from Stanford University.

Dr. James Meernik

**Acting Dean, Toulouse Graduate School
and Professor, Political Science**

Dr. James Meernik is an expert on United States foreign policy, post-conflict peace building, transitional justice, and international law. He has authored over fifty articles and book chapters and has authored or co-edited four books on international relations. He co-leads the UNT Study Abroad Program to the International Criminal Tribunal for the Former Yugoslavia, which won the American Political Science Association award for the most innovative course in the United States. An American Council on Education Fellow and a Fulbright Senior Specialist, he has conducted research in The Hague, Bosnia, Rwanda, and Arusha. Dr. Meernik holds a Ph.D. from Michigan State University.

SPEAKERS

Dr. Joseph Oppong

**Associate Dean of Research and Professional
Development and Professor, Geography**

Dr. Joseph Oppong is an expert on HIV/AIDS and co-directs UNT's Center for Computational Epidemiology and Response Analysis. His research focuses on computational epidemiology and disease mapping of tuberculosis genotypes and HIV/AIDS in Texas and Africa. Dr. Oppong has authored and edited nine books and numerous refereed journal articles and book chapters, chaired the Medical Geography Specialty Group of the Association of American Geographers, served as a panelist for the National Science Foundation, and mentored Graduate Research Fellowship Program recipients. He holds a PhD from the University of Alberta in Edmonton, Canada.

PARTICIPANTS

Contact

Bernal, Sonia	
Our Lady of the Lake	
Psychology; Counseling; Sports Psychology	-----
Brown, Samuel	
University of Arkansas - Little Rock	
English and Rhetoric	-----
Crichnigno, Jorge	
Northern New Mexico College	
Engineering	-----
Diaz, Amparo	
TAMU - Corpus Christi	
Sociology	-----

PARTICIPANTS

Contact

Eldridge, Keisharra University of Arkansas - Pine Bluff Analytical Chemistry	-----
Emanuelson, Richard Henderson State University Sociology	-----
Fearn, Cathy Sam Houston State University Sociology	-----
Garay, Veronica Our Lady of the Lake Experimental Psychology	-----
Hakeem, Lyn Southern University Social Work	-----
Harris, Wanda Henderson State University Social Work	-----
Jackson, Destiny Southern University Psychology	-----
Kincade, Crystal Lamar University Psychology	-----
Lewis, Ashley University of Arkansas-Pine Bluff Criminal Justice; Behavior Analysis	-----
McBride, Myia Henderson State University Dietetics/Nutrition	-----
McDonald, Hannah Tarrant County College	-----
Nguyen, An Thein Tarrant County College	-----
Phillips, Darrel UT San Antonio Psychology	-----

PARTICIPANTS

Contact

Price, Stephen Northern New Mexico College Computer Science; Mechanical Engineering	_____
Rivera, Ruben Northern New Mexico College Computer Science; Math	_____
Robles, Camilla Abilene Christian University Molecular Biology	_____
Rodriguez, Rafael UT San Antonio Math, Environmental Science	_____
Salas, Eric University of the Incharnate Word Sports Psychology	_____
Sanchez, Marsha University of the Incharnate Word Musicology; Organist	_____
Stephen, Krystal Sam Houston State University Counseling Psychology	_____
Tello, Ruby Texas A&M-Kingsville Social Work	_____
Urquhart, Jenny Northern New Mexico College Psychology	_____
Wamble, Konstance Southern Nazarene University Library Sciences	_____
Williams, Shannon University of Arkansas - Little Rock Public Administration	_____

CAMPUS MAP

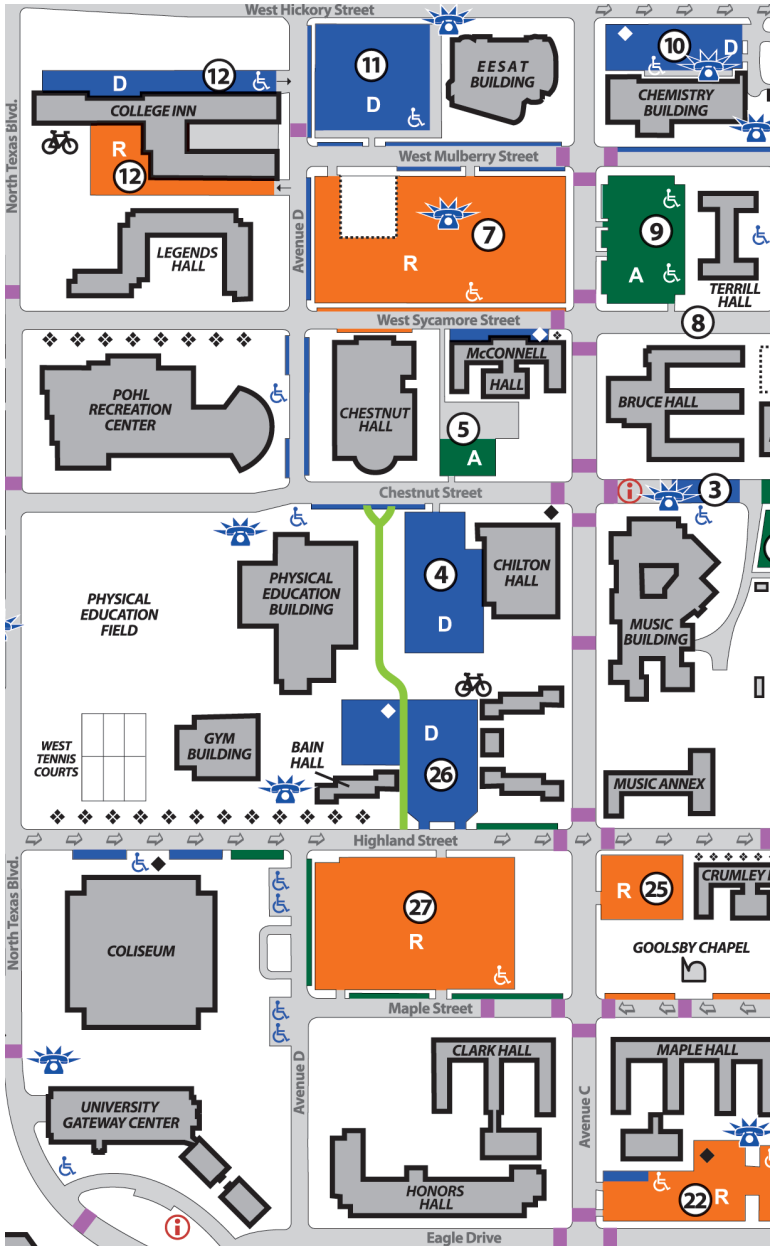

Map detail on p. 16

UNT Toulouse Graduate School

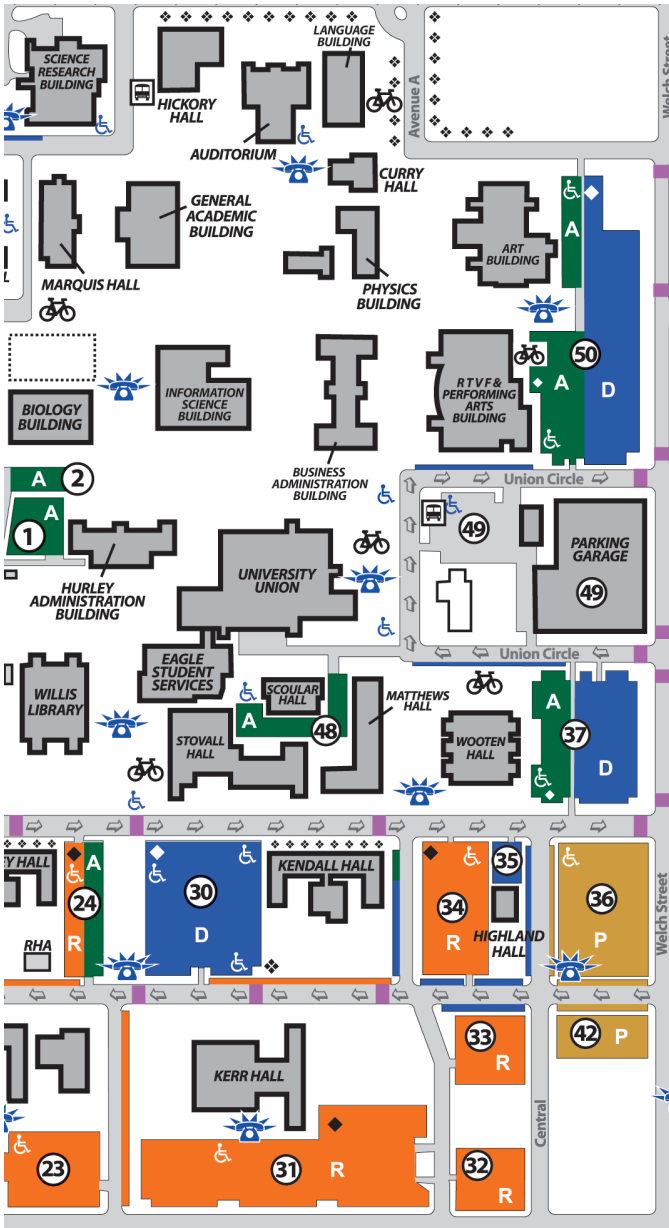

For a complete key to campus locations, see your UNT fold-out map

CAMPUS MAP DETAIL

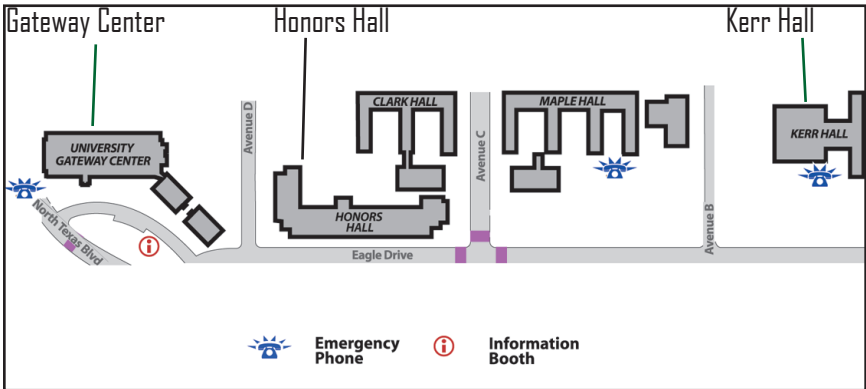

PROGRAM CONTACTS

Erin Belotte

Fellowships & Scholarships Coordinator

erin.belotte@unt.edu

940-565-4465

Dana Mordecai

Recruitment Coordinator

dana.mordecai@unt.edu

940-368-3271 (cell)

Dr. Victor Prybutok

Associate Dean of Academic Affairs

victor.prybutok@unt.edu

940-565-2088

Dr. Jim Meernik

Acting Dean

james.meernik@unt.edu

940-565-3946

UNT Police Department

Non-emergency

940-565-3000

Night escort

940-565-4838

Emergency

911

UNT Libraries

6 million cataloged items

extensive rare book and
Texana collections

\$3 million funding for
research in digital access
and preservation

UNT Top-Rated Graduate Programs

City Management and
Urban Policy

Rehabilitation Counseling

Counseling

Library and Information
Sciences

Political Science

Fine Arts

Clinical Psychology

Chemistry

Music

Biology

Environmental Philosophy

Business



Toulouse Graduate School
University of North Texas
1155 Union Circle #305459 (USPS)
1147 Union Circle, ESSC #354
Denton, TX 76203-5017
Phone: 888-UNT-GRAD
Email: graduateschool@unt.edu
Web: <http://www.tsgs.unt.edu>